

SAE Executive Standards Committee Rules provide that: "This report is published by SAE to advance the state of technical and engineering sciences. The use of this report is entirely voluntary, and its applicability and suitability for any particular use, including any patent infringement arising therefrom, is the sole responsibility of the user."

SAE reviews each technical report at least every five years at which time it may be revised, reaffirmed, stabilized, or cancelled. SAE invites your written comments and suggestions.

REV.  
E

AS85049™/91

FEDERAL SUPPLY CLASS  
5935

RATIONALE

REVISED TO INCLUDE NATURAL COLOR FOR COMPOSITE NONCONDUCTIVE FINISH AS COLOR OPTION CODE.

NOTICE

THE COMPLETE REQUIREMENTS FOR PROCURING THE PRODUCT DESCRIBED HEREIN SHALL CONSIST OF THIS DOCUMENT AND THE LATEST ISSUE OF AS85049.

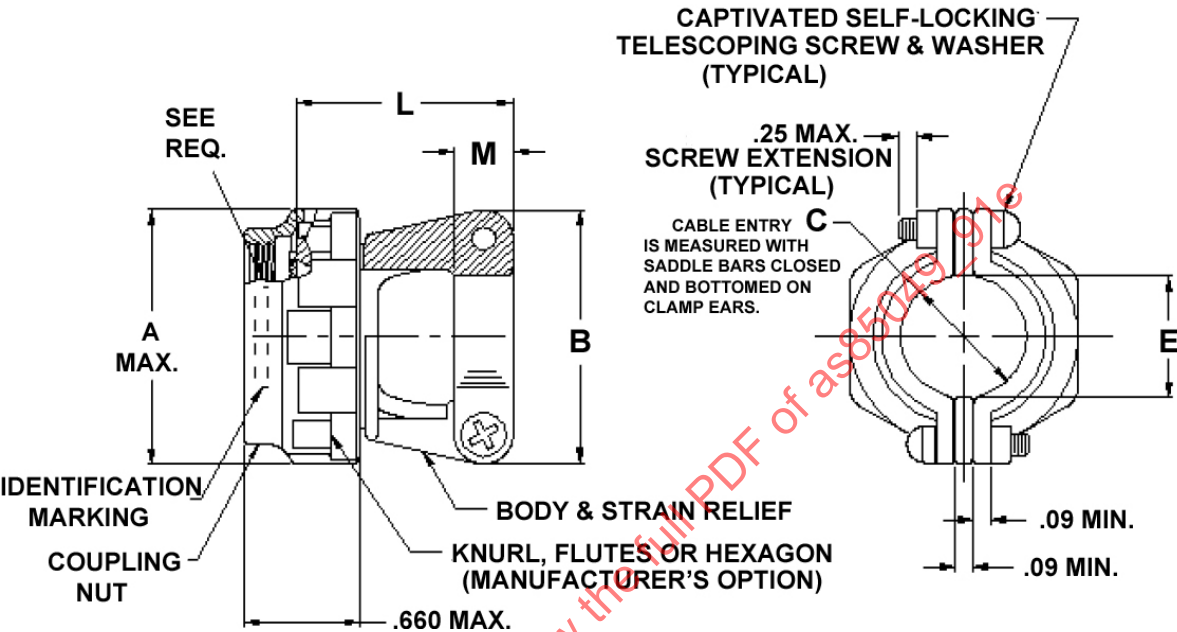

FIGURE 1 - CONFIGURATION AND DIMENSIONS

TABLE 1 - FIGURE 1 METRIC EQUIVALENTS

INCHES	MILLIMETERS	INCHES	MILLIMETERS
.09	2.29	.660	16.76
.25	6.35		

For more information on this standard, visit  
<https://www.sae.org/standards/content/AS85049/91E/>

THIRD ANGLE PROJECTION

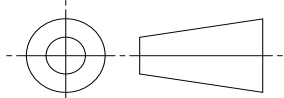

CUSTODIAN: AE-8C1

PROCUREMENT SPECIFICATION: AS85049



AEROSPACE STANDARD

CONNECTOR ACCESSORIES, COMPOSITE, ELECTRICAL,  
STRAIN RELIEF, STRAIGHT, SELF-LOCKING, CATEGORY 4C  
(FOR MIL-DTL-38999 SERIES III AND IV CONNECTORS)

AS85049™/91  
SHEET 1 OF 3

REV.  
E

**TABLE 2 - SHELL SIZES AND DIMENSIONS**

SHELL SIZE	A MAX DIA	B MAX	C ±.031 (0.78) DIA	E MIN	L MAX	M ±.03 (0.76)	SCREW SIZE
09	.858 (21.79)	.980 (24.89)	.219 (5.56)	.229 (5.82)	.840 (21.34)	.375 (9.53)	4-40
11	.984 (24.99)	1.05 (26.67)	.264 (6.71)	.274 (6.96)	.960 (24.38)	.375 (9.53)	4-40
13	1.157 (29.39)	1.20 (30.48)	.344 (8.74)	.354 (8.99)	1.100 (27.94)	.406 (10.31)	6-32
15	1.280 (32.51)	1.30 (33.02)	.460 (11.68)	.470 (11.94)	1.100 (27.94)	.406 (10.31)	6-32
17	1.406 (35.71)	1.42 (36.07)	.545 (13.84)	.555 (14.10)	1.230 (31.24)	.406 (10.31)	6-32
19	1.516 (38.51)	1.52 (38.61)	.615 (15.62)	.625 (15.88)	1.410 (35.81)	.406 (10.31)	6-32
21	1.642 (41.71)	1.64 (41.66)	.698 (17.73)	.708 (17.98)	1.510 (38.35)	.406 (10.31)	6-32
23	1.768 (44.91)	1.77 (44.96)	.780 (19.81)	.790 (20.07)	1.660 (42.16)	.406 (10.31)	6-32
25	1.890 (48.01)	1.89 (48.01)	.850 (21.59)	.860 (21.84)	1.760 (44.70)	.406 (10.31)	6-32

REQUIREMENTS: ALL REQUIREMENTS SHALL CONSIST OF THIS DOCUMENT AND THE LATEST ISSUE OF AS85049.

- DESIGN AND CONSTRUCTION: ACCESSORIES SHALL BE DESIGNED IN ACCORDANCE WITH FIGURE 1 AND TABLE 2. DIMENSIONS ARE IN INCHES. METRIC EQUIVALENTS IN PARENTHESES ARE FOR GENERAL INFORMATION ONLY. DIMENSIONS APPLY AFTER PLATING. PART SUPPLIED WITH STANDARD DETENTED SELF-LOCKING WHICH PROVIDES A POSITIVE AUDIBLE DETENTED COUPLING. OPTION "N" IS A FREE SPINNING SELF-LOCKING COUPLING.
- INTERFACE DIMENSIONS SHALL BE IN ACCORDANCE WITH AS85049, FIGURE 3 OR 3A.
- ACCESSORY SHALL CONSIST OF A COUPLING NUT, CLAMP STRAIN RELIEF, AND SADDLE BARS. THE COUPLING NUT SHALL BE CAPTIVATED TO THE CLAMP AND IS FREE TO ROTATE. ACCESSORIES SHALL NOT ACCOMMODATE CONNECTORS USING SIZE 8, 4, OR 0 CONTACTS.
- CLAMP SHALL HAVE NO PROTRUSIONS OR SHARP EDGES WHICH MAY PINCH CABLE OR WIRES.
- MATERIAL AND FINISH SHALL BE IN ACCORDANCE WITH AS85049 AND TABLE 3 HEREIN.
- CAPTIVATED SELF-LOCKING TELESCOPING SCREWS AND WASHERS SHALL BE 300 SERIES CORROSION-RESISTANT STEEL/PASSIVATED, SILVER PLATE OPTIONAL.

**TABLE 3 - MATERIAL AND FINISH**

MATERIAL	FINISH
COMPOSITE (CONDUCTIVE)	J - CADMIUM OLIVE DRAB <u>1/</u> <u>2/</u> M - ELECTROLESS NICKEL <u>1/</u> XC - NICKEL FLUOROCARBON POLYMER <u>1/</u> YC - PURE DENSE ELECTRODEPOSITED ALUMINUM <u>1/</u> ZC - ZINC NICKEL <u>1/</u> <u>2/</u>
COMPOSITE (NONCONDUCTIVE)	T - NATURAL COMPOSITE MATERIAL WITHOUT PLATING TB - BLACK COMPOSITE MATERIAL WITHOUT PLATING

1/ COUPLING NUT AND SADDLES MAY BE UNPLATED (NATURAL OR BLACK COLOR-MANUFACTURER'S OPTION).

2/ FINISHES NOT RECOMMENDED FOR USE IN APPLICATIONS THAT MAY BE SUSCEPTIBLE TO OUT GASSING (SEE SPECIFICATION NOTES).